

EXCEPTIONAL HYGIENE

HygiSeam™

Hygienic Insulated Panel w / EPS



INDUSTRY COMPLIANCE



INDUSTRY CERTIFICATIONS



HygiSeam™ W / EPS

Using the **HYGISEAM™** panel with Glasbord® W/ Surfaseal® and the HYGIFILL PU seam sealant together creates durable, cleanable, continuous smooth wall surfaces, eliminating unnecessary time and labour for sanitation. The HYGIFILL PU sealant enables panels to join almost seamlessly, preventing any growth of mold or mildew

Maintaining durability and cleanliness with frequent washdowns. **HYGISEAM™** panel combats this problem with the revolutionized caulking system, creating a permanent, unbroken seal that can take the pressure without needing constant attention.



Applications

- MEAT PROCESSING INDUSTRY
- POULTRY PROCESSING INDUSTRY
- FISH PROCESSING INDUSTRY
- DAIRY INDUSTRY BEVERAGE INDUSTRY
- FRUIT AND VEGETABLE INDUSTRY
- CONFECTIONARY INDUSTRY
- FREEZERS & COLD STORAGE
- CATERING
- INDUSTRIAL BAKERIES
- BLAST FREEZERS

KEY FEATURES:

- NON-RUSTING
- STAIN RESISTANT
- IMPACT RESISTANCE
- SEAMLESS WALL SYSTEM
- SUPERIOR HYGIENE
- DURABLE FINISH
- HACCP CERTIFIED
- REDUCED MAINTENANCE
- SAVES TIME AND LABOR
- WITHSTANDS AGGRESSIVE WASH-DOWN
- PREVENTS MOISTURE INTRUSION

the knowledge to produce solutions

FRONT (1ST Covering):

With our surfaces we distinguish between standard requirements (storage areas, Service rooms, etc..) and areas with highest demands (meat processing plants, slaughterhouses, etc..). We offer the ideal solution for every area using our GLASBORD® W/ Surfaseal® in compliance with HACCP standards

CORE MATERIAL:

The HYGISEAM™ sandwich panels (insulated panels) from Exceptional Hygiene can be used as partition panels, facade panels or ceiling panels, they are constructed from different core materials : EPS 20 - 240 mm, PIR 20 - 140 mm, R-P 45 - 220mm.

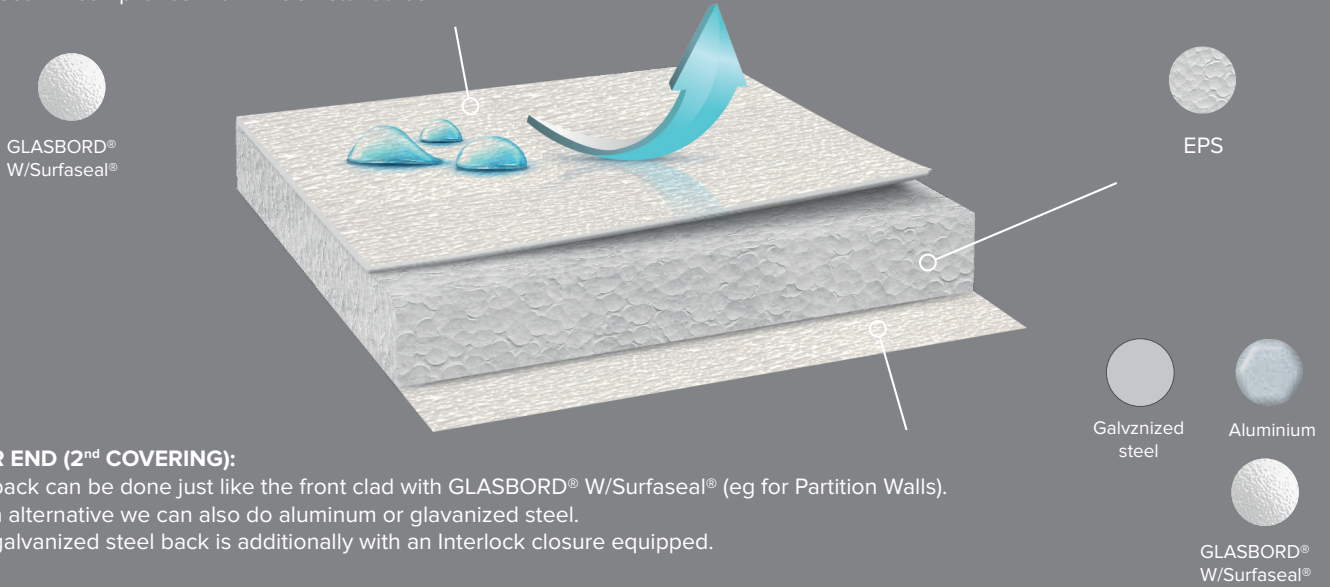

REAR END (2nd COVERING):

The back can be done just like the front clad with GLASBORD® W/Surfaseal® (eg for Partition Walls). As an alternative we can also do aluminum or galvanized steel. The galvanized steel back is additionally with an Interlock closure equipped.

Technical Data

Product Name	HYGISEAM™ (W/EPS)																														
Internal	<ul style="list-style-type: none"> • GLASBORD® W/ Surfaseal® embossed (Recommended for Food Processing plants), 																														
External	<ul style="list-style-type: none"> • As per internal skin • Steel galvanised 0,5mm (Z 275) covered Polyester SP 5 my or 25 my (RAL 9002) • Aluminum 																														
Core	<ul style="list-style-type: none"> • Polystyrene EPS 																														
Fire Resistance	<ul style="list-style-type: none"> • GLASBORD® W/ Surfaseal® : FM approved - Class A - Class C • Polystyrene EPS hardly flammable DIN4102-B1 • Polyisocyanurate PIR hardly flammable DIN4102-B1 																														
Insulation	<p>Thermal Conductivity of K= 0.032 KW/ mK (WLG 32)</p> <table border="1"> <thead> <tr> <th>Thickness (mm)</th> <th>Thermal Transmission U-Value (W/m².k)</th> <th>Thickness (mm)</th> <th>Thermal Transmission U-Value (W/m².k)</th> <th>Thickness (mm)</th> <th>Thermal Transmission U-Value (mm)</th> </tr> </thead> <tbody> <tr> <td>50</td> <td>0.591</td> <td>100</td> <td>0.303</td> <td>180</td> <td>0.173</td> </tr> <tr> <td>60</td> <td>0.489</td> <td>120</td> <td>0.255</td> <td>200</td> <td>0.156</td> </tr> <tr> <td>75</td> <td>0.389</td> <td>140</td> <td>0.22</td> <td>220</td> <td>0.142</td> </tr> <tr> <td>80</td> <td>0.375</td> <td>160</td> <td>0.193</td> <td>240</td> <td>0.13</td> </tr> </tbody> </table>	Thickness (mm)	Thermal Transmission U-Value (W/m ² .k)	Thickness (mm)	Thermal Transmission U-Value (W/m ² .k)	Thickness (mm)	Thermal Transmission U-Value (mm)	50	0.591	100	0.303	180	0.173	60	0.489	120	0.255	200	0.156	75	0.389	140	0.22	220	0.142	80	0.375	160	0.193	240	0.13
Thickness (mm)	Thermal Transmission U-Value (W/m ² .k)	Thickness (mm)	Thermal Transmission U-Value (W/m ² .k)	Thickness (mm)	Thermal Transmission U-Value (mm)																										
50	0.591	100	0.303	180	0.173																										
60	0.489	120	0.255	200	0.156																										
75	0.389	140	0.22	220	0.142																										
80	0.375	160	0.193	240	0.13																										
Sizes	<p>Width 1 m Maximum Length 8 m Thickness 50 - 240 mm</p>																														

Ease of installation

HYGISEAM™ (W / EPS) allows renovations of old walls and ceilings to be carried out by adapting to the existing context, without greatly reducing the useful surface areas of the premises. When the existing walls do not require the removal of old ducts or pipes, the installation time is reduced to a minimum thanks to an ingenious system: GLASBORD® W/ Surfaseal® profile is sufficient to ensure the implementation of the **HYGISEAM™** concept.

HYGISEAM™ (W / EPS)

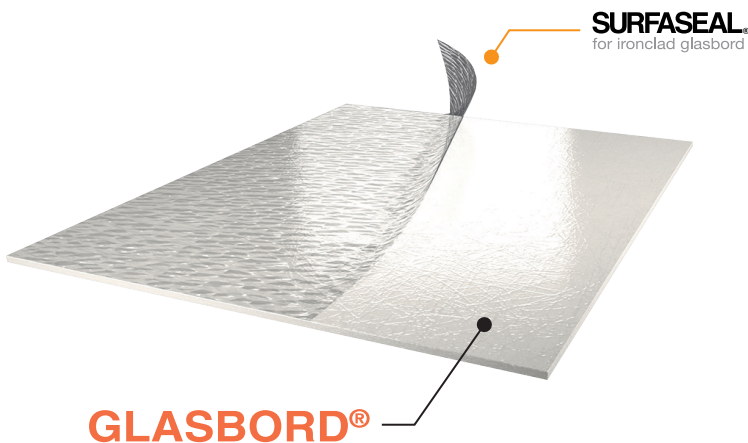
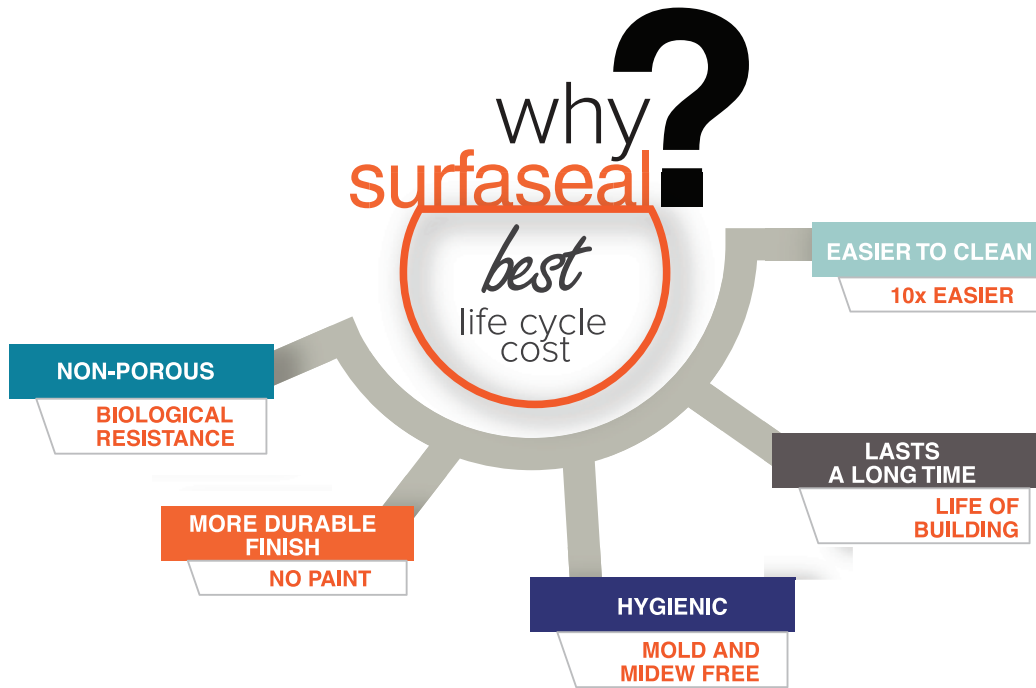
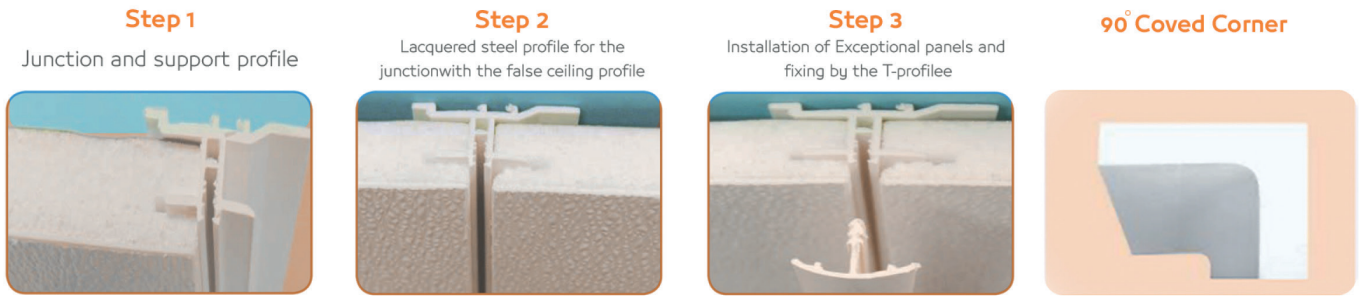

certificates and compliance:

INDUSTRY CERTIFICATIONS





INDUSTRY COMPLIANCE

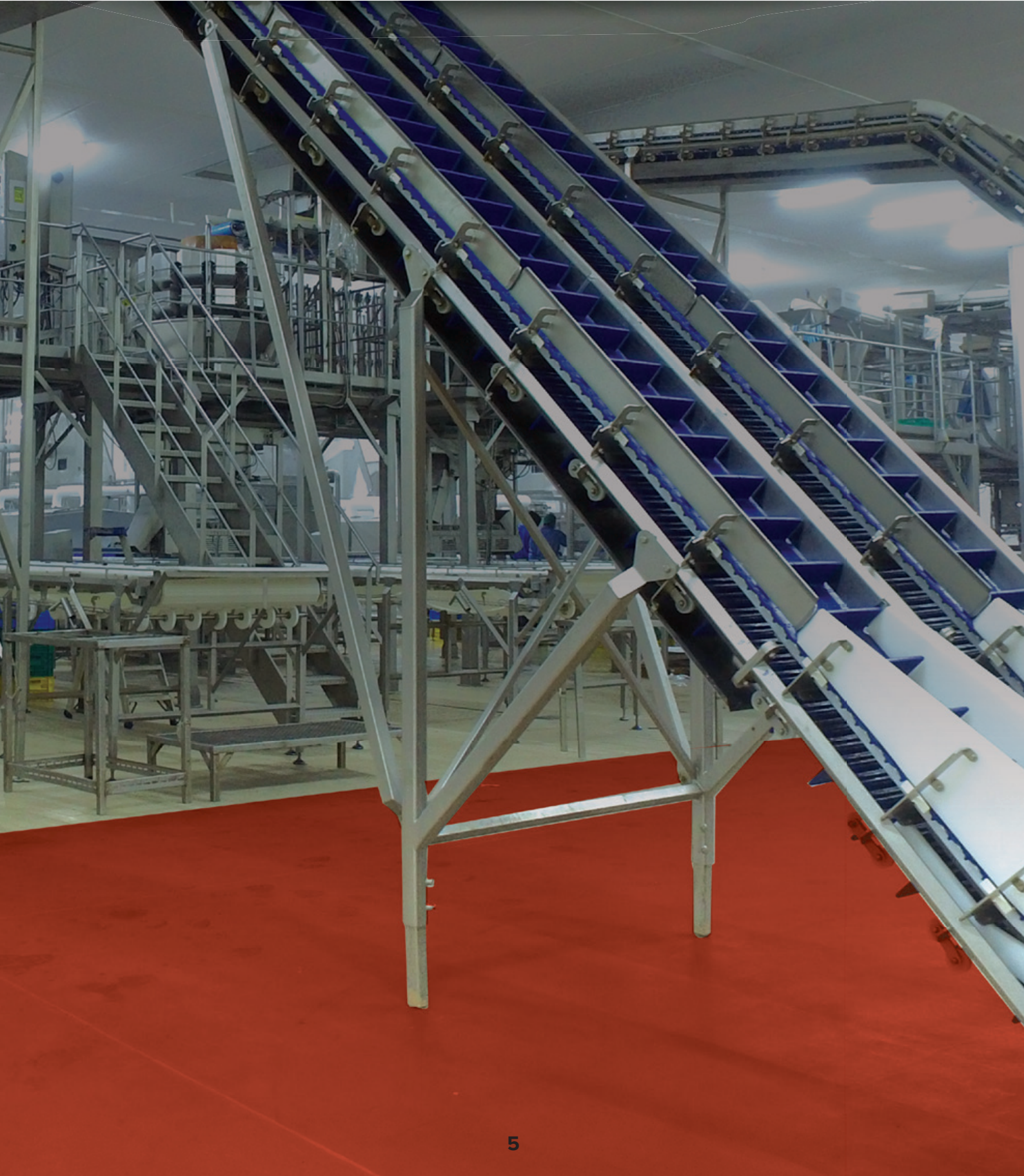



EXCEPTIONAL HYGIENE

 Saudi Arabia, P.O Box 53407,
Jeddah 21583 Al Khayat Tower,
Office No. 230

 +966 12 66 333 18
 +966 12 66 332 38
 info@exceptionalco.com

 www.exceptionalco.com